



MovingInn

St Asaph Road | | London | SE4 2ED

£1,695 Per Month

 **MovingInn**
sales, lettings & management

St Asaph Road |
London | SE4 2ED
£1,695 Per Month

Nestled on St Asaph Road in the vibrant area of New Cross, SE4, this charming ground floor flat offers a delightful living space perfect for a single professional. The property boasts a bright and airy atmosphere, enhanced by its well-designed layout and modern laminate flooring throughout.

The flat features a comfortable reception room with an open plan kitchen that serves as an inviting space for relaxation or entertaining guests. The bedroom is well-proportioned, providing a peaceful retreat at the end of a busy day. The bathroom is conveniently located, ensuring ease of access.

One of the standout features of this property is the private rear garden, a rare find in urban living. This outdoor space is ideal for enjoying a morning coffee or unwinding in the fresh air after a long day.

- Ground floor flat
- Laminate floors throughout
- Available from 7th February
- Excellent location
- Viewing recommended
- Private rear garden
- Bright and airy interior
- Ideal for single professional
- Close to transport links



Ground Floor
342 sq.ft. (31.8 sq.m.) approx.

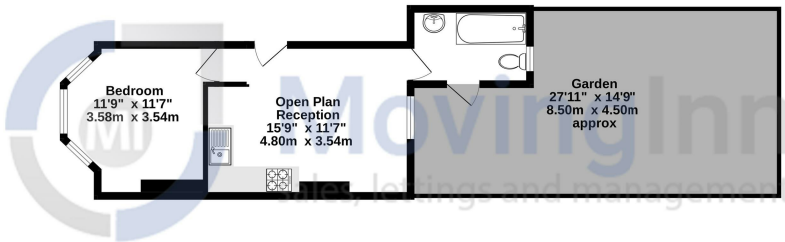

St Asaph Road, London, SE4
TOTAL FLOOR AREA: 342 sq.ft. (31.8 sq.m.) approx.
Measurements are approximate. Not to scale. Illustrative purposes only.
Made with Metropix (2023)

Energy Efficiency Rating		
	Current	Potential
Very energy efficient - lower running costs		
(92 plus) A		
(81-91) B		
(69-80) C	69	77
(55-68) D		
(39-54) E		
(21-38) F		
(1-20) G		
Not energy efficient - higher running costs		
England & Wales	EU Directive 2002/91/EC	

Council Tax Band B
EPC Rating C

467 Norwood Road
West Norwood
London
SE27 9DJ
02087610830
dean@movinginn.co.uk
www.movinginn.co.uk